



KNOCK-IT SYSTEM



THE KNOCK-IT SYSTEM is a wire suspension solution that can suspend applications from purlin steel work (cold rolled steel) with a vertical flange.

The system consists of a knock-on purlin fixing designed for a specific range of purlin thickness and a pre-determined length of wire rope and is supplied complete with an appropriate Zip-Clip locking device.

APPLICATIONS

SUITABLE AREAS OF USE INCLUDE, BUT ARE NOT LIMITED TO:

- Electrical containment
- HVAC and mechanical services
- Lighting and audio
- Signage and display, screens and partitions
- Acoustic ceilings, islands or baffles
- Radiant heat panels

SYSTEM	SUPPLIED LOCKING DEVICE	SWL (KG)	PURLIN THICKNESS (mm)
VLG	KL50	15	1-5
VLS	KL100	35	1-5
VLG/2	KL50	15	5-7
VLS/2	KL100	35	5-7

Note: G-system not recommended for HVAC.



FEATURES

- 18th Edition Amendment 2:2022 compliant.
- Available with both 1-5 mm and 5-7 mm purlin clips as standard.
- Choice of other hangers available on request.
- Key-free release suspension for height adjustability.
- High tensile galvanised steel wire rope.

AVAILABILITY

Zip-Clip offer four different Knock-It suspension options, each allocated a letter and number to differentiate between the available safe working loads (SWL) and available purlin clip sizes.

Each system comprises a predetermined length of a specific diameter wire rope and is supplied with the required Zip-Clip locking device.

Knock-It is available in drop lengths of 1 m to 10 m. Loads indicated are per individual wire support when coupled with the appropriate Zip-Clip locking device.

AREAS FOR USE

The standard Knock-It range is designed for indoor applications. Regular galvanised systems should not be used in areas that have levels of corrosion or elevated levels of heat or moisture.

For installations that are within corrosive areas consult with Zip-Clip Technical Department.

IMPORTANT NOTE:

- Confirm suitability of the anchor point and that it is satisfactory for the intended load.
- Carry out test fixes prior to installation to ensure compatibility between purlin and fixing.
- Ensure the loadings are within the purlin manufacturer's guidelines. If higher loading is required please refer to our wrap around systems.

SUITABLE BASE MATERIALS:

- Cold rolled purlin steel.
- Suitable for vertical flange only with thickness of between 1-7 mm.

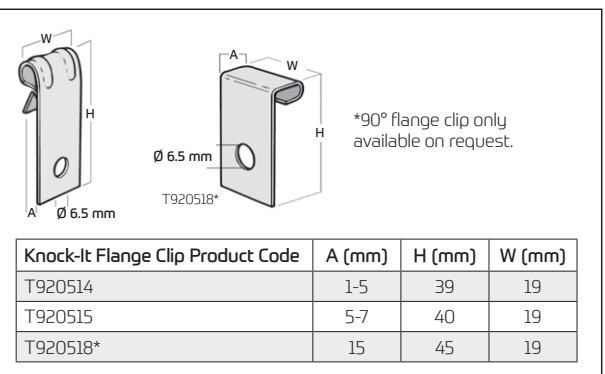



INSTALLATION

- Attach purlin fixing to vertical purlin flange using hammer.
- Connect wire support to application using the Zip-Clip locking device.

Important Note: Do not fit purlin clip to purlins which have a camber.

STEP 1:

1. Hook purlin clip over the lip of the purlin.
2. Strike purlin clip with hammer and ensure fixing is fully seated onto the flange.
3. Fixing must be installed perpendicular to the run of the purlin.

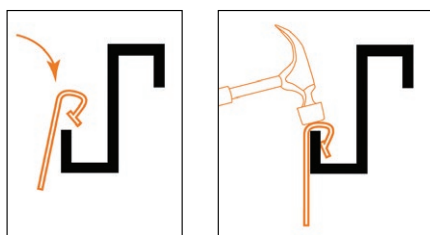

STEP 2:

1. Pass the wire rope through the Zip-Clip device in the direction of the arrow.
2. Pass wire rope through or around your required fixture/application and back through the Zip-Clip leaving 15 cm of wire protruding.
3. Confirm engagement of the Zip-Clip on the wire by pushing the pin in the **opposite** direction to the arrows indicated.

See Pages 5-7 and 30-31 for further information on the Zip-Clip locking device.



CODE	DESCRIPTION	SWL	PACK QTY
VLG1	1 m standard 1-5 mm decking suspension system	15 kg	10
VLG2	2 m standard 1-5 mm decking suspension system	15 kg	10
VLG3	3 m standard 1-5 mm decking suspension system	15 kg	10
VLG4	4 m standard 1-5 mm decking suspension system	15 kg	10
VLG5	5 m standard 1-5 mm decking suspension system	15 kg	10
VLG10	10 m standard 1-5 mm decking suspension system	15 kg	10
VLS1	1 m standard 1-5 mm decking suspension system	35 kg	10
VLS2	2 m standard 1-5 mm decking suspension system	35 kg	10
VLS3	3 m standard 1-5 mm decking suspension system	35 kg	10
VLS4	4 m standard 1-5 mm decking suspension system	35 kg	10
VLS5	5 m standard 1-5 mm decking suspension system	35 kg	10
VLS10	10 m standard 1-5 mm decking suspension system	35 kg	10
VLG1/2	1 m standard 5-7 mm decking suspension system	15 kg	10
VLG2/2	2 m standard 5-7 mm decking suspension system	15 kg	10
VLG3/2	3 m standard 5-7 mm decking suspension system	15 kg	10
VLG4/2	4 m standard 5-7 mm decking suspension system	15 kg	10
VLG5/2	5 m standard 5-7 mm decking suspension system	15 kg	10
VLG10/2	10 m standard 5-7 mm decking suspension system	15 kg	10
VLS1/2	1 m standard 5-7 mm decking suspension system	35 kg	10
VLS2/2	2 m standard 5-7 mm decking suspension system	35 kg	10
VLS3/2	3 m standard 5-7 mm decking suspension system	35 kg	10
VLS4/2	4 m standard 5-7 mm decking suspension system	35 kg	10
VLS5/2	5 m standard 5-7 mm decking suspension system	35 kg	10
VLS10/2	10 m standard 5-7 mm decking suspension system	35 kg	10

CODE	DESCRIPTION	SWL	PACK QTY
T920518	90 degree purlin clip for Kingspan	35 kg	10

